



FASTBIND ONE HANDY



TABLE OF THE CONTENT

1. INTRODUCTION	3
2. MAIN PARTS	4
3. OPTIONAL ACCESSORIES	6
4. TECHNICAL SPECIFICATIONS	7
5. INSTALLATION	8
6. SWITCHING ON	9
7. GLUE APPLICATOR	10
8. FUME EXTRACTOR	10
9. ADDING GLUE	11
10. BINDING A SOFT COVER BOOK	12
11. BINDING A HARD COVER BOOK	14
12. CLEANING THE GLUE TANK	16
13. MAINTENANCE	17
14. COPYRIGHT, TRADEMARKS AND WARRANTY	18
15. DISPOSAL	18
16. DECLARATION OF CONFORMITY	19

1. INTRODUCTION

Congratulation for purchasing this Fastbind ONE Handy perfect binder. Fastbind ONE Handy is a professional manually-operated EVA and PUR perfect binder. ONE Handy is the only ONE machine you need for all your binding jobs.

The new improved Paper Grain Opener (PGO 5), glue applicator and sturdier body add more precise control to the binding process than ever before.

Designed for short and medium digital printing environments, the ONE Handy from Fastbind gives you the control you need and the speed you want to bind soft and hard cover books, in-house.

Main features:

- Can use PUR and EVA glue, in the same tank.
- Binds hard covers books, soft covers books and paperbacks, tear-off pads and more.
- From miniature to 33 x 33 cm (including A4 portrait and landscape)
- With EVA glue, no cleaning necessary
- With PUR glue, easy daily cleaning and optional fast cleaning kit.

Before installing and operating Fastbind ONE Handy the safety instructions and recommendations given in this User's Manual should be studied carefully. This way you can get the most out of your new binding machine and operate it safely.

2. MAIN PARTS

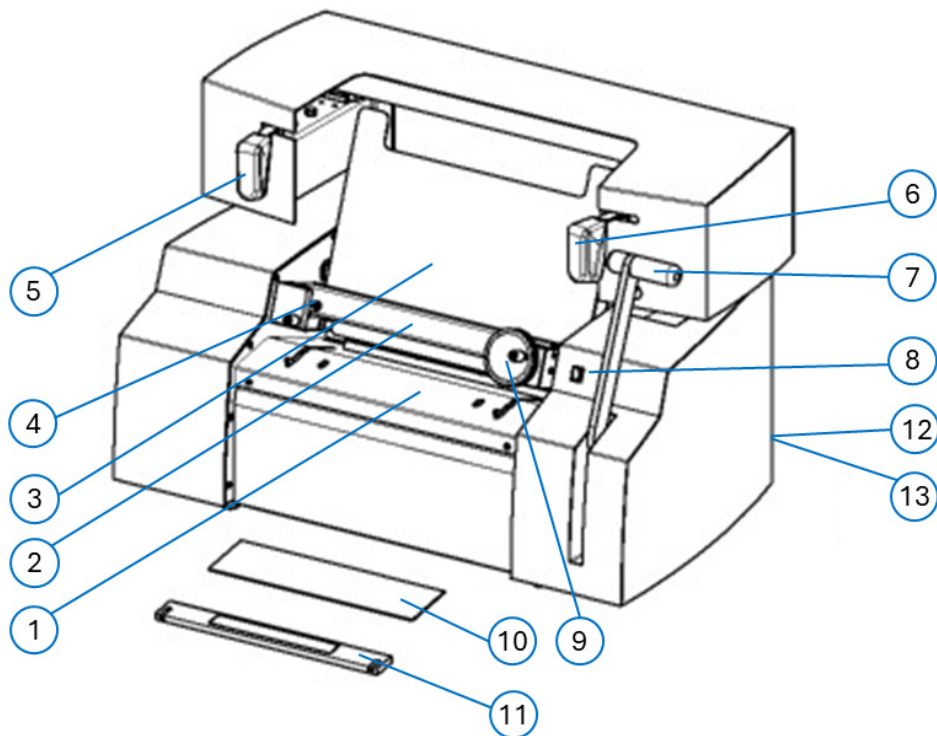
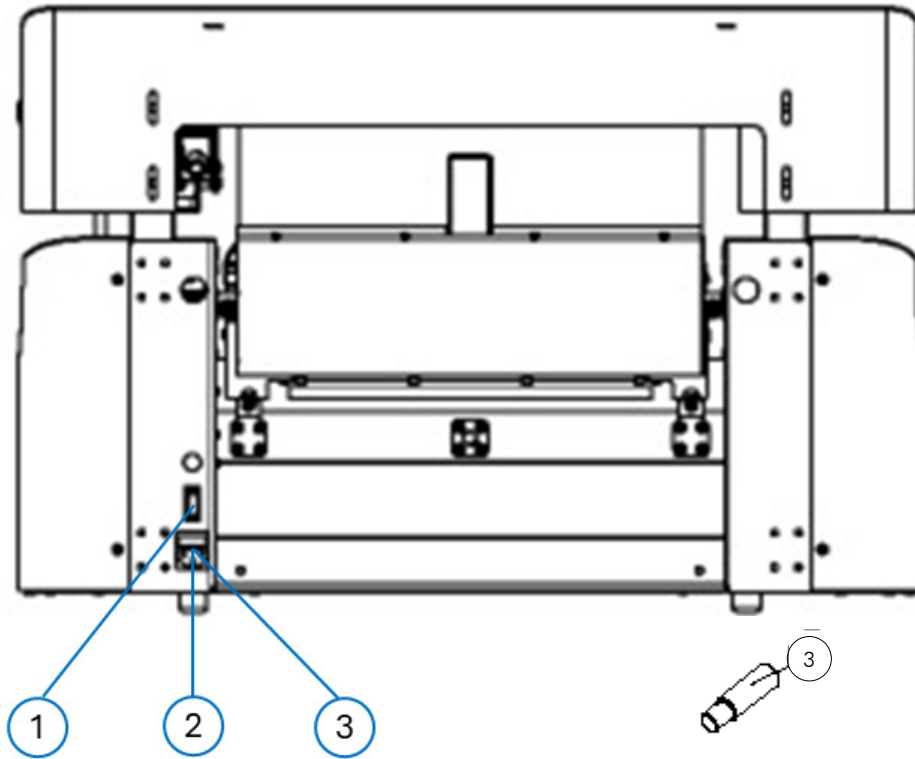

Figure 1

1. Positioning deck
2. Sesame clamp bar
3. Turntable
4. Paper guide for hard covers
5. PGO 5 - Roughening handle
6. Applicator handle
7. Turntable handle
8. Temperature selection button for EVA or PUR glue
9. Sesame wheel to close/open the clamp
10. Soft cover pad
11. Soft cover nipping bar
12. Main Switch
13. Main socket + fuse 6,3 A(T)

2. MAIN PARTS



1. Main switch
2. Main socket
3. Fuse 6,3A

3. OPTIONAL ACCESSORIES



- 1. Hard cover toolkit
 - 1.1 Hard cover nipping bar
 - 1.2 Hard cover guide
- 2. PGO5 (Paper Grain Opening System)

4. TECHNICAL SPECIFICATIONS

	Metric measurements	USA / Imperial measurements
Machine dimensions (w x d x h)	88 x 55 x 55 cm	34.65 x 21.65 x 21.65 inches
Machine weight	55 kg	121 lbs
Capacity soft cover books/hour*	180 books/hour (cycle speed: 240 cycles/hour)	180 books/hour (cycle speed: 240 cycles/hour)
Capacity hardcover books/hour*	90 books/hour (cycle speed: 120 cycles/hour)	90 books/hour (cycle speed: 120 cycles/hour)
Binding thickness min/max	0.1–50 mm	0.004–19 inches
Maximum book length (spine)	Up to 330 mm	Up to 13 inches
Min/Max. binding height	Up to 335 mm	Up to 13 inches
Maximum thickness of cover material	Up to 400 gr soft cover - Up to 5mm thick hard cover.	Up to 225 index soft cover - Up to 0.2" thick hard cover.
Voltage (V) / Frequency (Hz)	220–240 / 50–60	110-120 / 50–60
Glue temperature on high setting	Type 10.0 glue	Type 10.0 glue
Glue temperature on low setting	For PUR glue and stand-by mode	For PUR glue and stand-by mode
Max. current	3 A	5.5 A
Approvals	CE	CE
Optional accessories available:		
Easy clean kit for PUR glue	Yes	Yes
Hard cover tool kit	Yes	Yes
Roughening unit	Yes, PGO Gen 5 (Paper Grain Opening)	PGO Gen 5 (Paper Grain Opening)

* Depends on operator and book size

Product information as of December 2024 and is subject to change without notice

5. INSTALLATION

Before installing and operating Fastbind ONE Handy, please study carefully the safety instructions and recommendations given in this User's Manual. This way you can get the most out of your new binding machine and operate it safely.

CHOOSING LOCATION

1. Lift the machine from the pallet and place it on a solid work surface. The recommended table height is 90 cm (36 inches) and the minimum loading capacity is 200 kg (440 lbs.).

WARNING! The machine weighs 55 kg (122 lbs.).

2. Fastbind book binding machines are designed for indoor use. Avoid drafty, moist and dusty environment. For normal operation, the ambient temperature range should be +15 to +30°C.

POWER SUPPLY

3. Before using the machine, check that the operating voltage indicated on machine's identity plate corresponds with the voltage of the power source. This plate is located at the rear of the machine.

4. This unit may only be connected to properly earthed power outlet. When unplugging the power cord, always grasp the plug to pull it out.

5. Never damage, modify or place heavy objects on the power cord. Do not use the machine while the power cord is bundled or knotted.

6. Switch off the unit and pull out the mains plug prior to all cleaning and maintenance.

PUR GLUE / FUME EXTRACTION

7. Hot PUR glue emits fume containing isocyanate. Glue fumes can be harmful. Read the material safety data sheet for the PUR – glue before using the glue. Do not use PUR glue without proper ventilation. It is recommended to connect a sufficiently powerful fume extraction device to collect fume emissions. For improved extraction, we recommend the Fastbind optional fitting kit. Always follow all local and federal guidelines for proper ventilation!

GLUE TANK

8. Foreign objects or substances in the glue tank can seriously damage the glue applicator. Do not re-use hot melt drops from the drop cards! Keep the glue applicator cap on and except when adding hot-melt adhesive.

9. Hot-melt glue, glue roller and glue tank are hot and can cause skin burns. Let the machine cool down properly before touching this area.

In case of burns:

- Immediately cool affected skin areas using cold, clean water
- Do not forcefully remove hot melt material from the skin
- Immediately seek medical attention

SAFETY

10. Do not attempt to alter or modify the machine. It contains high-voltage components and unexpected faults or electric shock might occur. Modification will also invalidate the warranty.

11. Use only original accessories and spare parts approved by the manufacturer to ensure that the unit can be operated safely. For service and maintenance, contact Fastbind authorized service outlet.

12. Do not pour liquids on the machine as it could damage electronic parts and cause short cut.

6. SWITCHING ON

Switching on the machine

Check that power cord is connected to main supply and switch the machine on (see chapter 2 Main parts, figure 1, number 12 and 13)

Selecting the glue type

You can select the glue temperature depending on the type of glue in the tank (PUR, EVA or others) with the temperature switch (see chapter 2 Main parts, figure 1, number 8)

- For EVA or metallocene glue, press the switch up, for a higher temperature.
- For PUR glue, press the switch down, for a lower temperature.

We recommend that you switch the machine to “Low Temperature” mode when not using it for periods over 30 minutes. It will take just 5 minutes to warm back up to higher temperature when needed.

Operating the machine

- Install the soft cover nipping tool for soft cover books (marked S) or hard cover nipping tool for hard cover books (marked H)

The hard cover nipping tool is not included but provided as an optional accessory.

- The machine needs to warm up properly before it is ready to use (20 min).
- Turn the machine off when you have finished working with it. Even if the machine has unlimited continuous working time, leaving it on and idle degrades the hot melt slowly. This can lead to adhesive ‘overcooking’, which blocks the glue roller.

We recommend that you switch the machine to “Low Temperature” mode when not using it for periods over 30 minutes. It will take just 5 minutes to warm back up to higher temperature when needed.

7. GLUES AND GLUE APPLICATOR

PUR (Polyurethane) hotmelt glue

PUR glue is used for papers that are difficult to bind with EVA glue or for very thick books to added flexibility of the spine.

- Sold in granules, recommended glue: Technomelt PUR 3317 BR Hot Melt, Fastbind product code 718028
- A fume extraction system is recommended. If using a fume extractor, Fastbind fitting kit is also recommended. The unit should not be operated without proper ventilation.
- If the glue applicator is not cleaned daily after use, the PUR glue solidifies and the applicator has to be replaced. Contact Fastbind for more information.
- Select the low temperature setting on the glue switch (pressing down) for PUR glue.

EVA (Ethylene-Vinyl Acetate) and type 10.0 Hotmelt glue

Recommended glue: Fastbind hot melt type 10.0, for normal binding operations.

- Generic glue for normal papers
- The type 10.0 glue and EVA adhesives can be left in the tank at all times (no need for draining or cleaning).
- Select the high temperature setting on the glue switch (pressing up)

Cleaning the tank of PUR glue

- After finishing the book binding, the PUR glue always needs to be drained, flushed with EVA glue and emptied from the tank (see chapter 12) at the end of each day and at the latest 6 hours after use. Otherwise the PUR glue will solidified in the tank and the glue applicator will be unusable
- Any damage due to improper draining and cleaning of the PUR glue is not covered by the warranty.
- See chapter 12

8. FUME EXTRACTOR

Extractor hood and readiness for fume extraction

- Either a connection to your existing external/outside ventilation or a fume extraction unit is recommended for all PUR glue operations. No fume extraction device is included in the delivery.

Connection to the extractor hood

- The machine can be connected to an external fume extractor. An easy fitting kit for hose connection adaptor can be purchased from Fastbind.

WARNING!

- Hot PUR glue emits fume containing isocyanate. Glue fumes can be harmful. Read the material safety data sheet for the PUR –glue before using the glue. Do not use PUR glue without sufficient fume extraction or proper ventilation. Follow all local and federal guidelines for proper ventilation.

9. ADD MORE GLUE TO THE TANK

- Recommended glues are Fastbind hot melt type 10.0 and Fastbind PUR Technomelt. Caution: using other than Fastbind adhesives will invalidate the warranty and the manufacturer is not responsible for any damage caused.
- Keep the glue reservoir cap on except when adding hot-melt adhesive.

WARNING! Hot-melt glue and parts around the glue applicator are hot and can cause skin burns. Let the machine cool down properly before touching this area.

In case of burns: Immediately cool affected skin areas using cold, clean water. Do not forcefully remove hot melt material from the skin. Seek medical attention immediately

Selecting the glue type

You can select the glue temperature depending on the type of glue in the tank (see chapter 7)

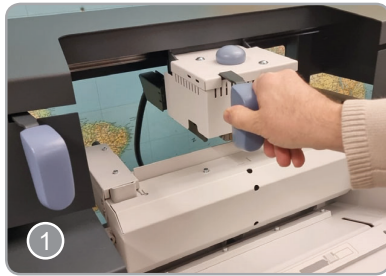

After the machine has warmed up for at least 10 minutes, bring the applicator at the center of the rail. Do not try to rotate the roller by force.

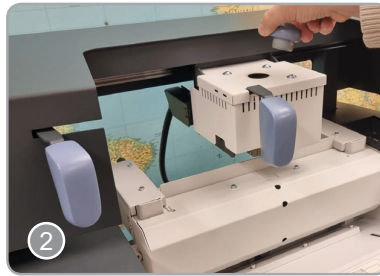

Remove the glue tank cap and check the glue level. Hot-melt adhesive should always cover the holed minimum level plate on bottom of the applicator.

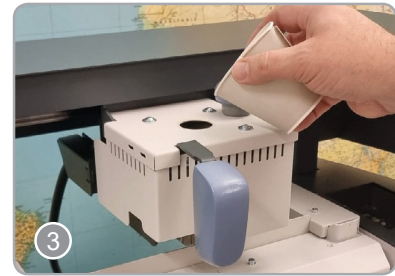

If needed, add more glue to the tank. Take care not to overfill the tank. Add only new, clean and dry glue to the tank.

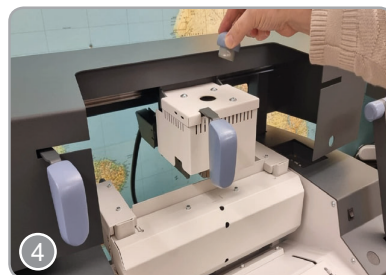

WARNING: Glue roller is a high precision part and designed for paper contact only. Foreign objects such as paper clips or staples could damage it easily.

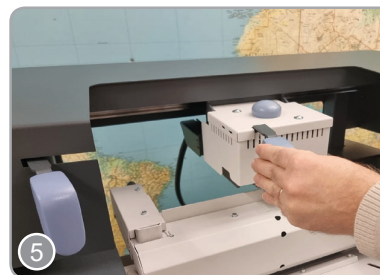

For optimal operation, add small amounts regularly and let the glue melt properly. Keep the glue reservoir cap on except when adding hot-melt glue.



Bring the glue applicator back to its home position. You're ready to continue binding.



10. BINDING A SOFT COVER BOOK



To bind a soft cover, you will need the soft cover magnetic pad and the soft cover nipping bar (marked with an "S")



Place the pad on the positioning deck and the nipping bar on the two side hooks.

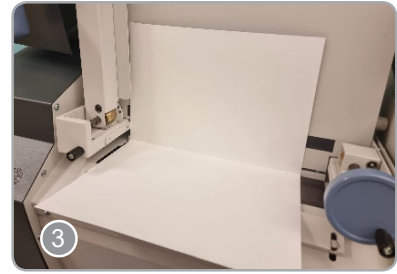

Place the cover so that the front page faces the turntable. Align it on the left.



Carefully jog the pages that make up the book. Place your bookblock and align it with the cover.



Lower the clamp arm until it clicks on its support.

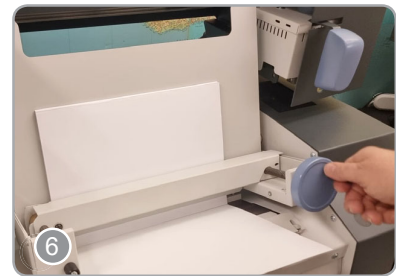

Turn the blue Sesame crank until the clamp touched the paper.

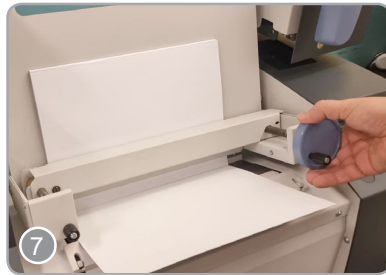

Give the Sesame crank an extra quarter turn manually. Now, your papers are secured under the clamp bar.



Turn the table up by lifting the hand lever of the machine. Caution: do not slam the turntable against the table limit stops. This could damage the machine.



Gently run the PGO roughener along the book spine back and forth as many times as necessary depending on book thickness and paper type. No force is necessary.



With both hands, gently squeeze the spine to remove excess air after the roughening cycles.



Run the glue applicator along the spine using the four step method illustrated on the right. Note that the glue is not applied right to the edge with every pass.

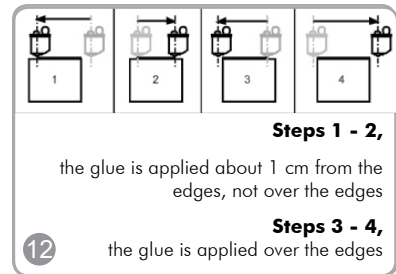

This gives the highest binding strength without excess glue and can be recommended with all soft covers and all types of glue.



13
 Immediately after the glue application, you can pull slightly from the cover for a spiderweb effect. This improves side gluing between cover and first page.



14
 Turn the table back into the starting position by pulling the hand lever down and holding the cover as shown above. Press the lever all the way down for the nipping.

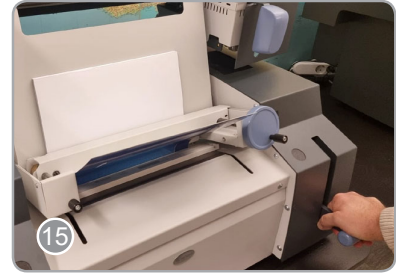

15
 Given that hot melt tacks (starts to dry) in 2-3 seconds, swift but gentle actions provide the best result. Caution: Do not slam the table.

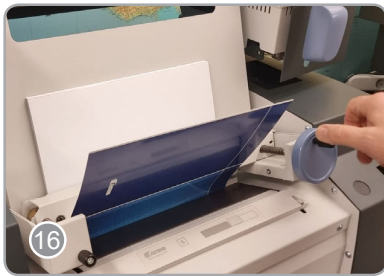

16
 Unlock the clamp by turning the blue Sesame crank anti-clockwise.



17
 Once unlocked, you can lift the Sesame arm of the clamp.

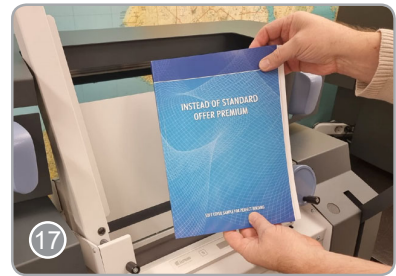

17
 Your soft cover book is ready. The spine is perfectly square.

11. BINDING A HARD COVER BOOK

NOTE: You will need the hard cover toolkit accessory to bind hard cover books with Fastbind ONE Handy.



To bind a hard cover, you will need the hardcover guide and the hard cover nipping bar (marked with an "H")



Place the nipping bar on the two side hooks.

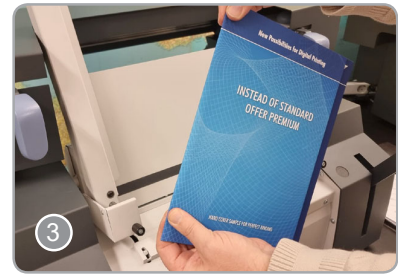

Fold your hard cover sharply along the front edge of the spine.

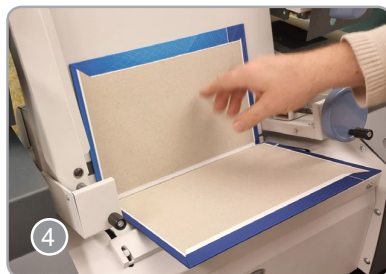

Place the cover so that the front page faces the turntable. Make sure that the spine stick is lying flat on the position deck.



Align the cover on the left. Pull out the paper guide and slide the cover under its rim. The collar will hold the cover safely in place.

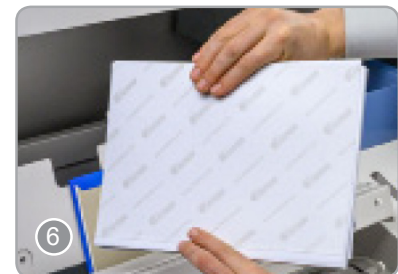

Place a Fastbind endpaper as first and last page (with the Fastbind logo outside), with the glue-free area on the spine side.



Carefully jog the pages that make up the book. Place your book block and align it with the cover.

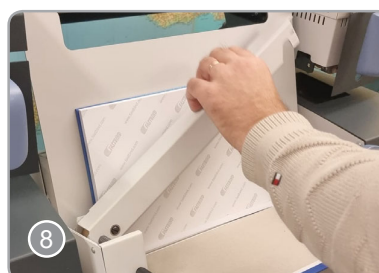

Lower the clamp arm until it clicks on its support.



Turn the blue Sesame crank until the clamp touched the paper.

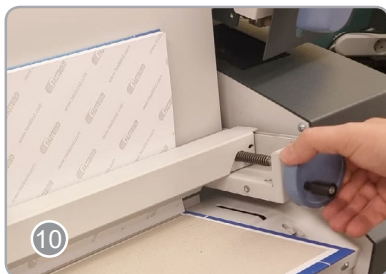

Give the Sesame crank an extra quarter turn manually. Now, your papers are secured under the clamp bar.



Turn the table up by lifting the hand lever of the machine. Caution: do not slam the turntable against the table limit stops. This could damage the machine.



Gently run the PGO roughener along the book spine back and forth as many times as necessary depending on book thickness and paper type. No force is necessary. Squeeze the spine to remove excess air.



Run the glue applicator along the spine using the four step method illustrated on the right. Note that the glue is not applied right to the edge with every pass.

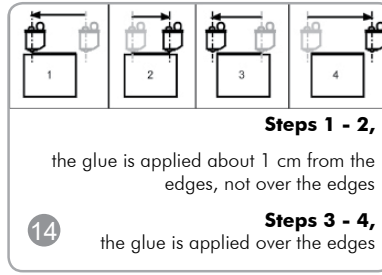

This gives the highest binding strength without excess glue and can be recommended with all hard covers and all types of glue.

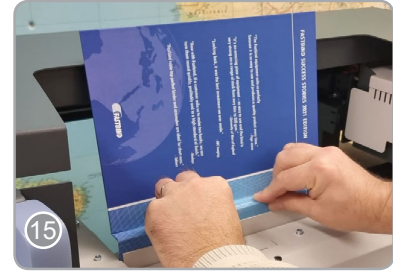

After gluing, fold the cover to dip the spine stick in the glue and gently press on the spine.

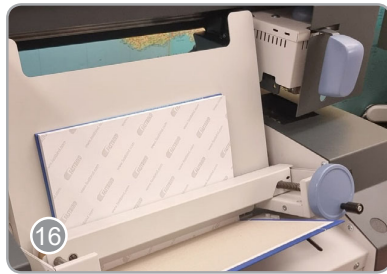

Turn the table back into the starting position by pulling the hand lever down and holding the cover as shown above. Press the lever all the way down for the nipping.



Given that hot melt tacks (starts to dry) in 2-3 seconds, swift but gentle actions provide the best result. Caution: Do not slam the table. Unlock the clamp by turning the blue Sesame crank anti-clockwise. Once unlocked, lift the Sesame arm of the clamp.

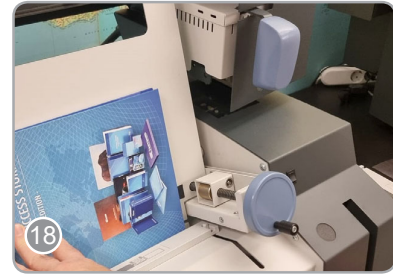

Release the book. Turn it over and press on the lever again to press the groove on the front side.

Attaching the endpapers



To attach the Fastbind end papers to cover, lift the book on top of the clamp and open the cover.



Peel the silicon lining paper away.



Bend the cover slightly to arc and close it. Turn the book over, repeat process on the other side.

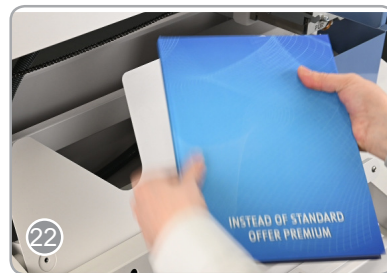

To finish the spine, press your fingers together and follow the folding line all the way down.



To finalize the book, apply pressure on the endpapers (both sides) to ensure proper tacking.



The book is ready for use.

12. CLEANING THE GLUE TANK

How to drain the glue tank

WARNINGS

Hot PUR glue emits fume containing isocyanate. Glue fumes can be harmful. Read the material safety data sheet for the PUR –glue before using the glue. Do not use PUR glue without sufficient fume extraction or proper ventilation. Follow all local and federal guidelines for proper ventilation.

The applied glue is hot! DO NOT TOUCH ANY HOT SURFACE AT ANY TIME OR YOU RISK INJURY. Do not touch the glue!

RECOMMENDATION! It is recommended to connect a sufficiently powerful fume extraction device to the extractor hood to collect fume emissions. Always follow local rules and regulations.

BEFORE DRAINING

Place a gray board (chip board) on the positioning deck, the rear edge against the back support.

Put a stack of papers (approximately 4 cm/ 1.5" thick) on the position deck in portrait position (the short edge against the deck). Close the clamp and turn the table to gluing position.

The glue has to be melted before the glue cartridge can be drained. Use the PUR temperature setting for PUR glue and the EVA setting for EVA glue.

DRAINING THE PUR GLUE

Cover the book block spine with gray board so that the long edge of the board is towards you (the long edge is parallel with the glue applicator rail).

Move the heating dock sideways close to the book block by using the applicator handle. Move the gray board against the back wall. Apply a sufficient amount of glue on the gray board by moving the unit back and forth from applicator handle.

Stop the heating dock in the middle of the paper block. Remove the gray board by pulling it towards yourself, throw out the greyboard. Move the heating dock right over the edge of the paper block.

Repeat the steps until the glue roller stops applying glue on the gray board and it is empty, add a small amount of type 10.0 glue and repeat twice.

Leave a small amount of type 10.0 glue in the cartridge.

13. MAINTENANCE

Cleaning

This binding machine is easy to take care of and will serve you well if it is regularly cleaned. Use a soft, damp cloth with an alcohol-based solvent or mild detergent solution for this purpose. Do not use solution containing ammonia or abrasive.

At the end of each day, you can remove any glue drop fallen on the machine. Allow glue drops to cool down before removing.

Cleaning the clamp rods

Apply a small drop of oil weekly on the rods to maintain it in proper condition.

14. COPYRIGHT, TRADEMARKS AND WARRANTY

Copyright information

© 2024 Copyright Maping Co. Reproduction, adaptation or translation without prior written permission is prohibited, except as allowed under the copyright laws. The information contained herein is subject to change without notice.

Trademarks and patents

Fastbind is a trademark of Maping Co. Fastbind ONE Handy is invention of Maping Co (patents pending).

One year limited warranty

Maping co warrants this product against defects in material or workmanship as follows: for the period of twelve months from the date of purchase, repair or replace free of charge, for the original purchaser, any part or parts found by inspection to be defective by our factory authorized service outlet or by the manufacturer at Espoo, Finland. All transportation charges on parts submitted for repair or replacement under this warranty shall be paid for by the purchaser. All service under this warranty will be furnished and performed by factory authorized service stations or by the manufacturer. Warranty service does not extend the warranty period. This warranty is limited to the value of the product and it does not cover damage caused by:

- Transportation
- Normal wear and tear
- Neglected or improper maintenance
- Misuse

The warranty will be voided if machine's type plate has been wholly or partially removed or erased. Maping Co is not responsible for any damages, including but not limited to direct, indirect or consequential damages, loss of material, profit or interruption of business. Maping Co may at any time discharge its warranty by refunding the purchase price and taking back the product.

15. DISPOSAL

Disposal



The crossed-out wheeled-bin symbol on your product, literature, or packaging reminds you that in the European Union all electrical and electronic products, batteries, and accumulators must be taken to separate collection at the end of their working life. Do not dispose of these products as unsorted municipal waste.

Return the products to collection to prevent possible harm to the environment or human health from uncontrolled waste disposal and to promote the sustainable reuse of material resources. Collection information is available from the product retailer, local waste authorities or national producer responsibility organizations.

Contact information

Fastbind Maping Co

P.O. Box 10, FIN-02601 Espoo, FINLAND

Tel. +358 10 3254 600

Email: info@fastbind.com

16. DECLARATION OF CONFORMITY

We, Fastbind mapiing Co, hereby declare that following products:

Machine names Fastbind ONE Handy

Type Book binding machine

Corresponding model numbers 9780 and 9781

Applied standards



The products fulfill the essential safety requirements for CE conformity marking according to the Low Voltage Directive 2014/35/eu and EMC Directive 2014/30/EU
62368-1:2014 (safety)
IEC/EN 61000-6-3: 2011 (EMC emission)
EN 61000 - 6-1: 2016 (EMC immunity)

Manufacturer

Fastbind - Mapiing Co
P.O. Box 10, FIN-02601 Espoo, FINLAND
Tel. +358 10 3254 600

Espoo, 1.09.2024



Jaakko Huotari, Managing Director

